

UNIVERSAL INSTRUCTIONS

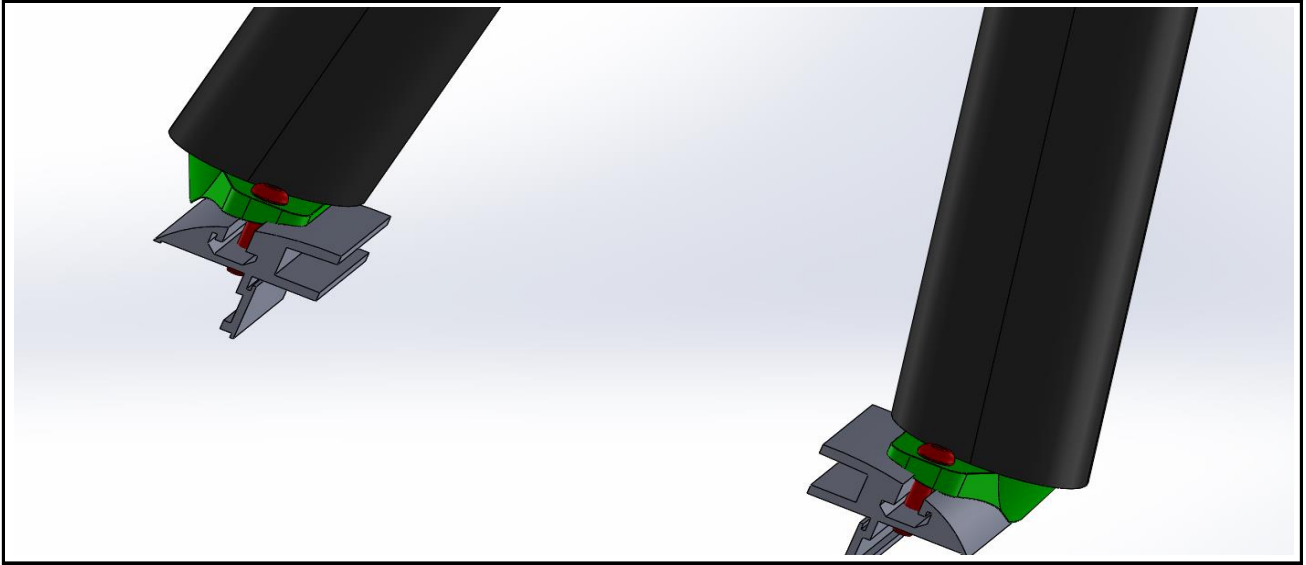

Components & Tools

Images to be added....

M8 tap
7.5mm drill bilt
tape measure
vernier / caliper

Process

- 1 Remove factory sport bar from vehicle and install RVE Shutterlid as per product instructions. Remove any mounting brackets attached to the sport bar.
- 2 Measure the distance between the grooves of the tracks. Measure the distance from inner edge of one side to outer edge of the other (This is the most accurate way to determine the centre-centre distance). For Purposes of the instructions, this is called distance A, assumed to be 1505mm (default value for Ford Ranger)

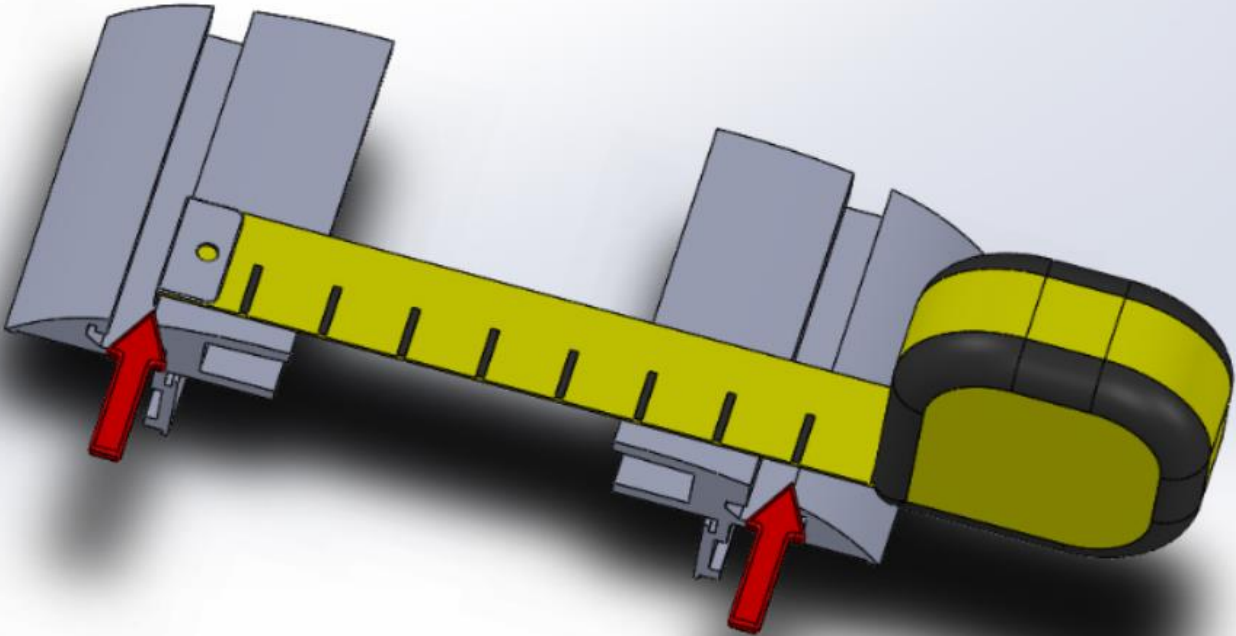

- 3 Measure the distance between the inner edges of both front posts of the sport bar. For purposes of the instructions, this is called distance B, assumed to be 1445mm (default value for Ford Ranger FX4 sport bar)

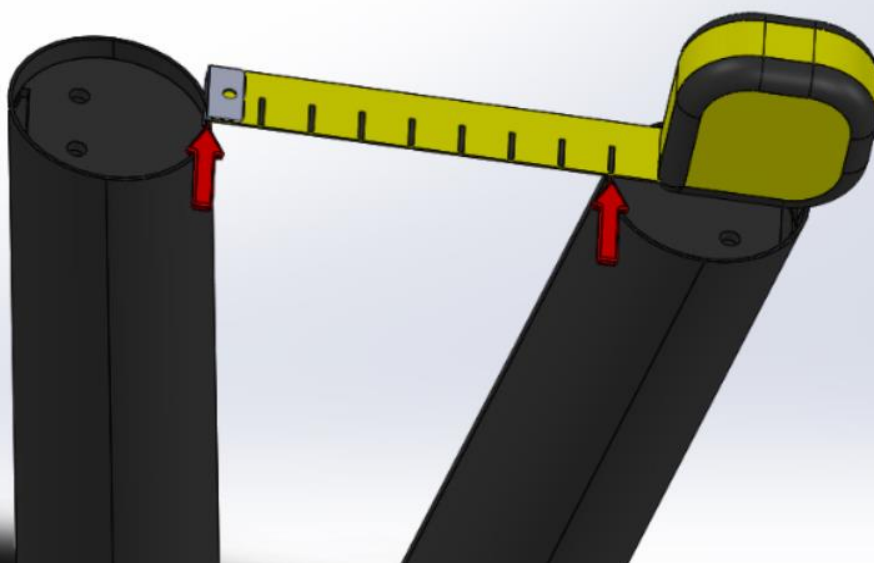

4

Do the following calculation:

Subtract distance B from distance A.

$$1505\text{mm} - 1445\text{mm} = 60\text{mm}$$

Add 20mm

$$60\text{mm} + 20\text{mm} = 80\text{mm}$$

Divide the distance by 2.

$$80\text{mm} / 2 = 40\text{mm}$$

This measurement is the distance from the inner edge of each sport bar front post, to where the brackets need to bolt onto.

5

Using a vernier or similar measuring tool, measure the distance calculated above, from the inner edge of each post. If there are predrilled holes at this distance, the brackets can be bolted onto the sport bar using these holes. If not, mark these points to be drilled (Where possible, locate as close to the centre line of the post. The brackets are slotted to allow for slight variations).

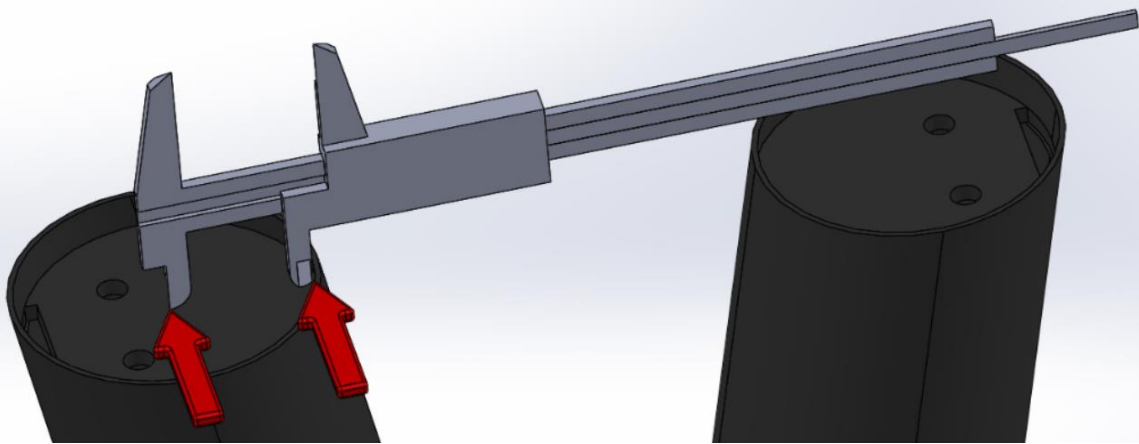

- 6** Drill pilot holes, followed by 7.5mm. Be sure to use sharp drill bits and be careful not to burn the drill bit when drilling through stainless steel.

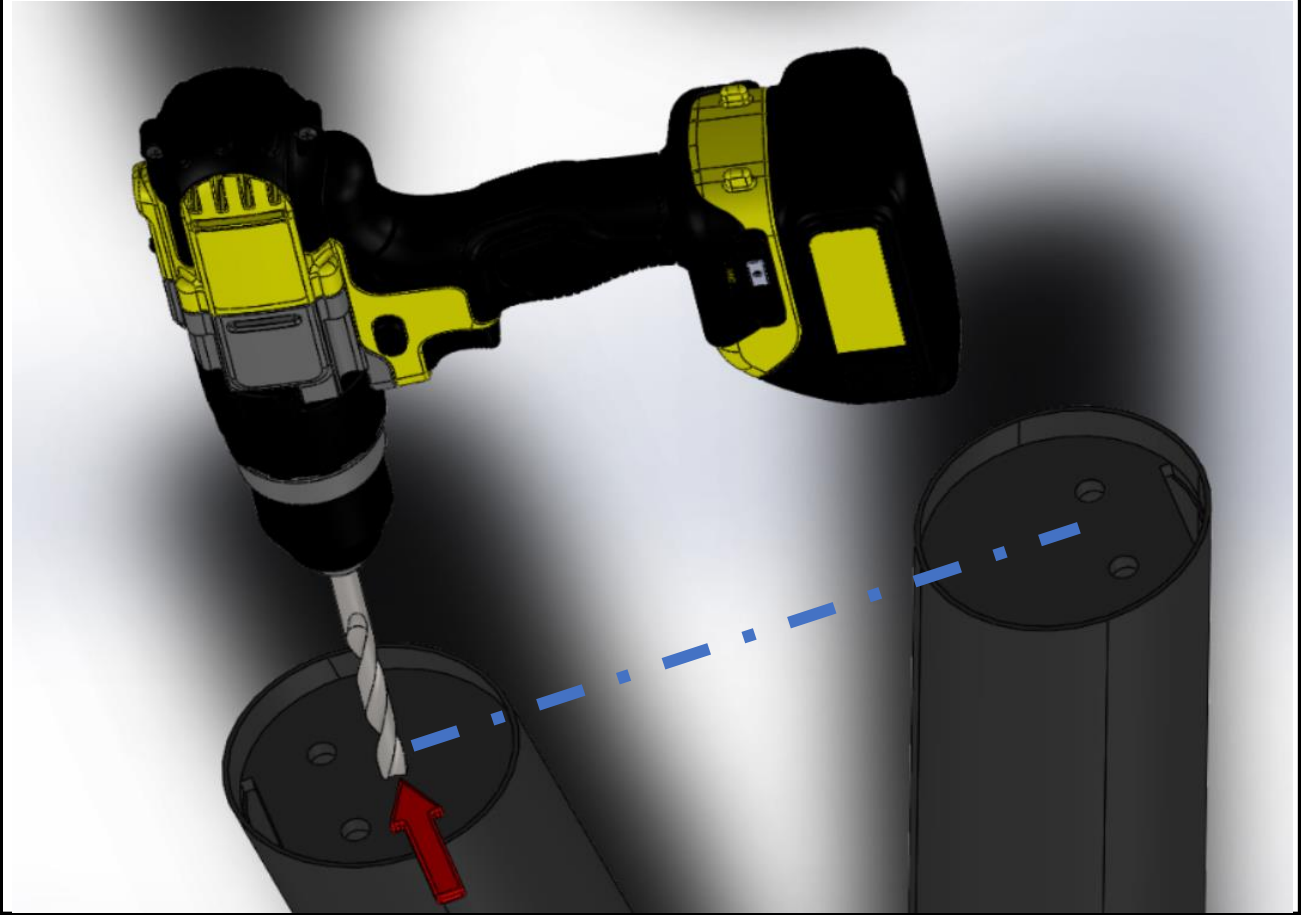

- 7** Tap the drilled hole using a M8 x 1.25 tap. Lubricate with machine oil to prevent the tap from breaking in the process.

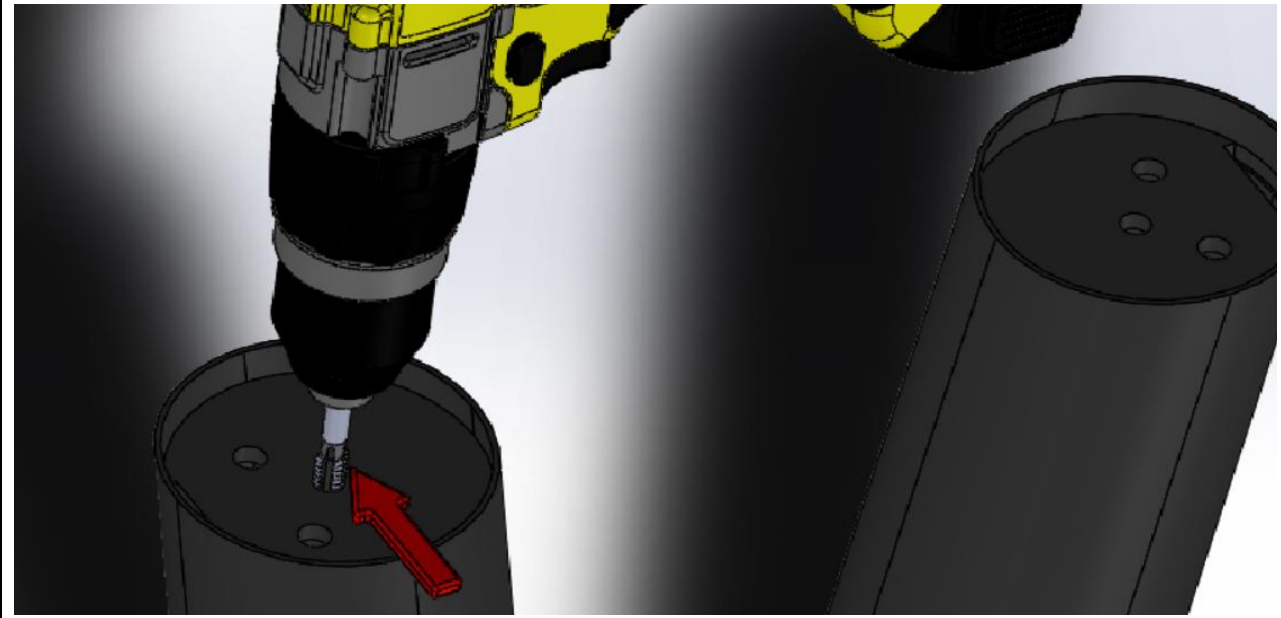

8

Bolt the aluminium brackets onto the sport bar, using M8 x 35mm (or longer if required) button head bolts. It is advisable to use a thread lock compound like Loc-tite. Measure the distance between the mounting holes of both side posts. This should match the initial measurement between the track slots (Measurement A, done in step 2)

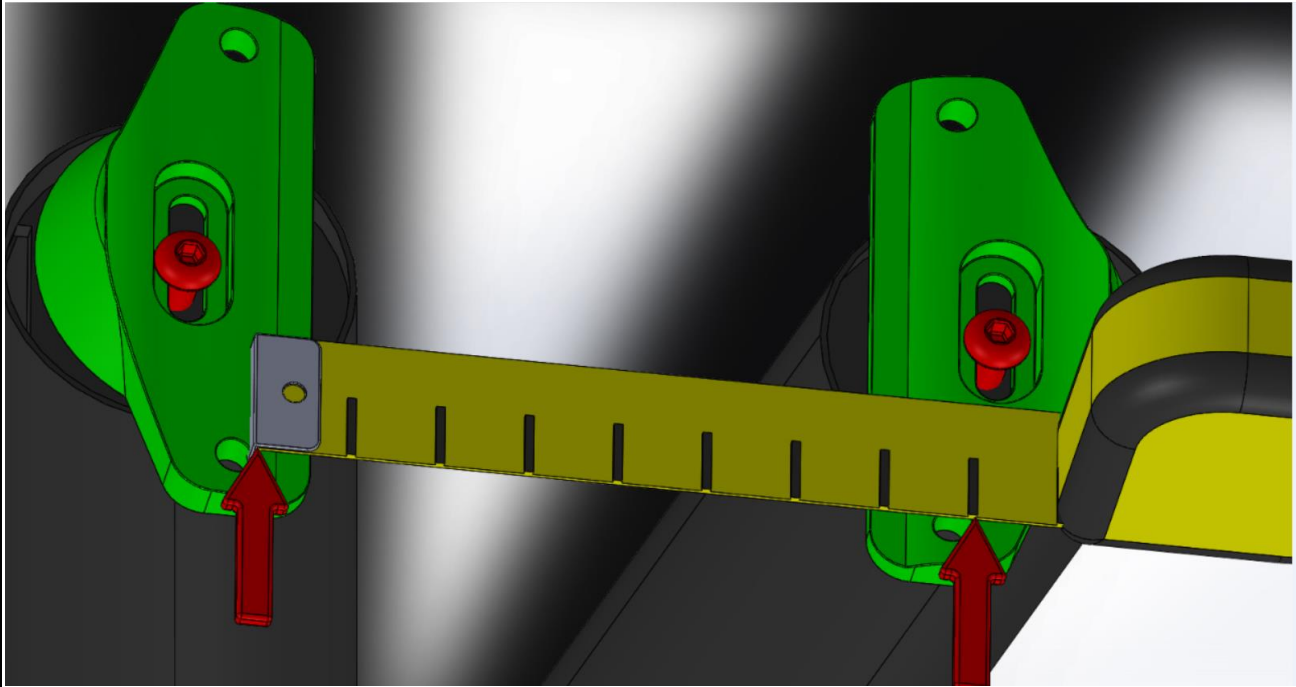
**9**

Repeat the process for the rear posts of the sport bar as well. Note that especially with modular extended sport bars, the rear bars should have enough flex available to be able to mount these using factory drilled and tapped holes. Usually, a difference of 20mm overall should work just fine. Once this step is done, mount the sportbar onto the RVE shutter lid, using M8 x 25 button head bolts, 8mm springwashers, 8mm washers and 8mm slide nuts, provided in the kit.

RVE PERSONALISED VEHICLES

0800 738 7648 (NZ FREECALL) | rve.co.nz

1800 639 103 (AUSTRALIA FREECALL) | rveinternational.com